



SUPERSTACK® II DUAL SPEED HUB – PS HUB CASCADE CONVERTER KIT

3C16692



USER GUIDE

The SuperStack® II Dual Speed Hub – PS Hub Cascade Converter Kit is used for connecting the SuperStack II Dual Speed Hub 500 to a SuperStack II PS Hub.

PS Hubs have four separate 10Mbps segments (segments 1–4) which are extended through a stack of PS Hubs by the PS Hub's cascade cables, as shown below. The Cascade Converter Kit allows you to connect segment 1 of the PS Hub stack directly to the Dual Speed Hub 500 stack's 10Mbps segment (and the 100Mbps segment, through the internal switch). This allows the workstations that are connected to that PS Hub segment to communicate with the 10Mbps and 100Mbps workstations and equipment that are connected to the Dual Speed Hub 500 stack.

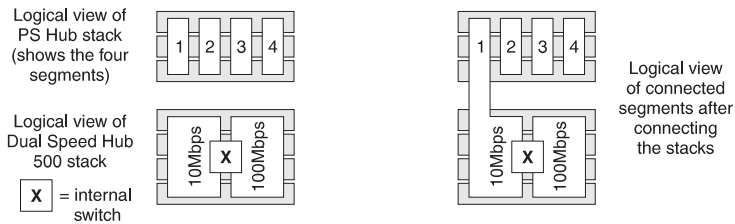

i The maximum number of PS Hub units and Dual Speed Hub 500 units that you can connect using the Cascade Converter is eight. You can have a maximum of 6m (19.6ft) of cascade cabling (including the cable that connects the PS Hub stack and Dual Speed Hub 500 stack) between the top and bottom units.

The Cascade Converter Kit is made up of a Cascade Cable and a Cascade Converter. Connect the Cascade Cable to the 'Dual Speed Hub Cable' end of the Cascade Converter (indicated on top of the Cascade Converter), as shown below.

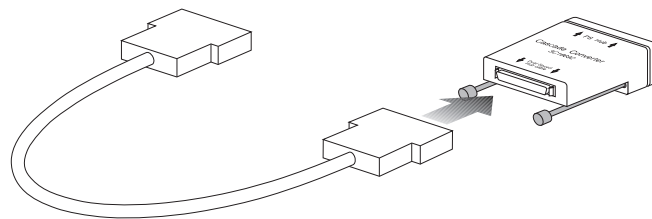

Dimensions

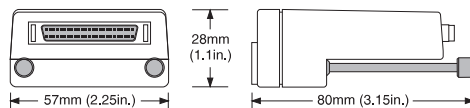

Using the Cascade Converter Kit

The Cascade Converter Kit links the bottom unit in your PS Hub stack to the top unit in your Dual Speed Hub 500 stack, so the PS Hub stack should be above the Dual Speed Hub 500 stack.



For safety information, refer to the information in the user guides that accompany the Dual Speed Hub 500 and the PS Hub.

1 Connecting to the PS Hub

To connect to the PS Hub, connect the Cascade Converter to the DOWN port of the bottom unit in the PS Hub stack, as shown below.

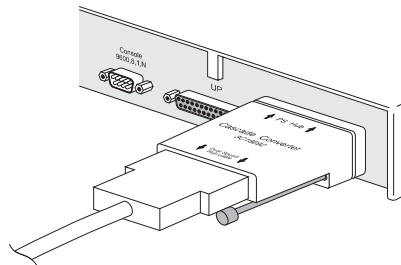

2 Connecting to the Dual Speed Hub 500

To connect to the Dual Speed Hub 500, connect the Cascade Cable (that is connected to the Cascade Converter) directly to the UP port of the top unit in the Dual Speed Hub 500 stack, as shown below.

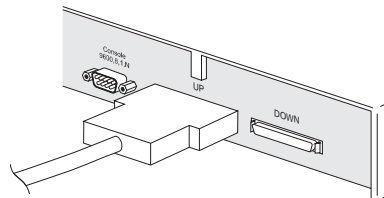

If you are using Hot Swap Cascade Units with your Dual Speed Hub 500 stack or PS Hub stack, you can connect the Cascade Converter Kit directly to these Hot Swap Cascade Units.

Part No. DUA1669-2AAA01 / Published October 1997

© 3Com Technologies, 1997. All rights reserved. No part of this documentation may be reproduced in any form or by any means or used to make any derivative work (such as translation, transformation, or adaptation) without permission from 3Com Technologies. 3Com and SuperStack are registered trademarks of 3Com Corporation. Unless otherwise indicated, 3Com registered trademarks are registered in the United States and may or may not be registered in other countries.